

## UPB 125 • Installation Guide

### IMPORTANT SAFETY INSTRUCTIONS

#### Read all instructions before starting installation.

When using this projector mount, always follow basic precautions, including the following:

**CAUTION:** Risk of Personal Injury. Maximum projector weight for the UPB 125 is 40 lbs (18.1 kg).

**ATTENTION :** Risque de blessure grave. Le poids maximum du projecteur pour le UPB 125 est 18,1 kg (40 lbs).

#### SAVE THESE INSTRUCTIONS

**NOTE:** Refer to local building standards and codes to verify that the installation will meet the regulatory requirements. Observe all local and national building and safety codes, UL requirements, and ADA accessibility guidelines.

The UPB 125 is a versatile projector mount that works with most projectors weighing up to 40 pounds (18.1 kg) and accepts a 1.5 inch -11.5 NPT/NPS pipe.

The flexibility of the UPB 125 allows for quick dismantling and remounting of the projector to the support pipe.

The UPB 125 consists of two parts: the upper Pipe Adapter Block **A**, which mounts onto the projector pipe, and the lower Base Plate Assembly **B** which attaches directly to the projector (see image at right).

For product specifications visit [www.extron.com](http://www.extron.com).

#### PROPER MOUNTING PROCEDURES MUST BE FOLLOWED.

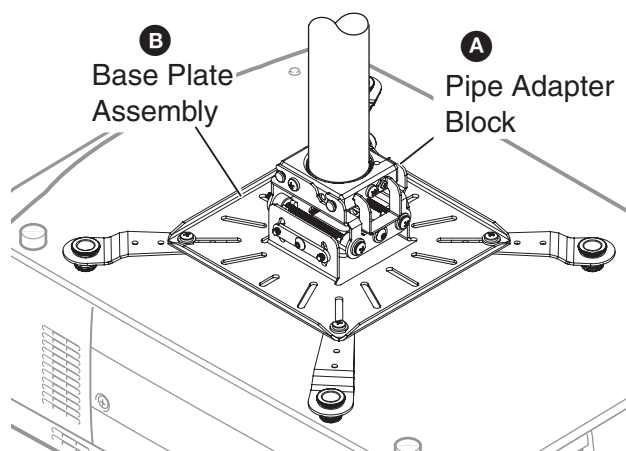

#### Before Starting the Installation:

##### Check the Projector

- ☐ **Weight** — The UPB 125 can mount a projector with a maximum weight of 40 pounds (18.1 kg).
- ☐ **Mounting points** — Use all available mounting points (typically three or four) on the projector base to securely attach the projector.
- ☐ Check the minimum and maximum throw distance of the projector. See the projector documentation for details.
- ☐ Check the projector lens offset. See the projector documentation for details.

##### Check the Mounting Location

- ☐ Check the structural ceiling to ensure that it can support a load four times the total weight of the final setup.

#### UPB 125 Included Parts

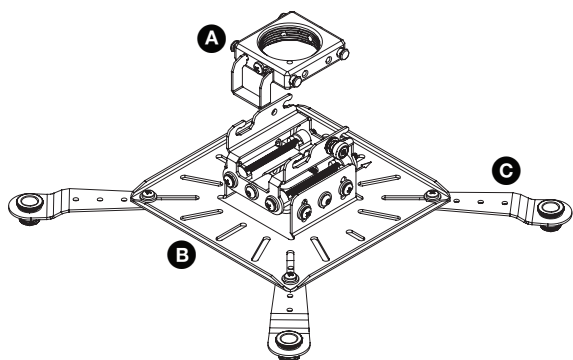

Item	Part	Qty.
<b>A</b>	Pipe Adapter Block	1
<b>B</b>	Base Plate Assembly	1
<b>C</b>	Arms, arm securing screws (M5x10 mm) and washers, projector mounting barrels	4 each
<b>D</b>	Mounting screws (M4x8 mm, M5x12 mm, M6x12 mm)	4 each
<b>E</b>	Lock screw (M5x10 mm)	1 each

# UPB 125 • Installation Guide (Continued)

## Installing the UPB 125

### Preparation

Separate the two main parts (Pipe Adapter Block **A** and Base Plate Assembly **B**) of the UPB 125 (see the figure at right).

### Installing the Base Plate Assembly on the Projector

1. Invert the projector on a protected surface to access the mounting points.
2. At the end of the arm **C**, rotate the barrel so that it protrudes from the base of the arm about 1/4 inch.
3. Select the correct sized projector mounting screws **D** that fit the projector mounting point inserts.

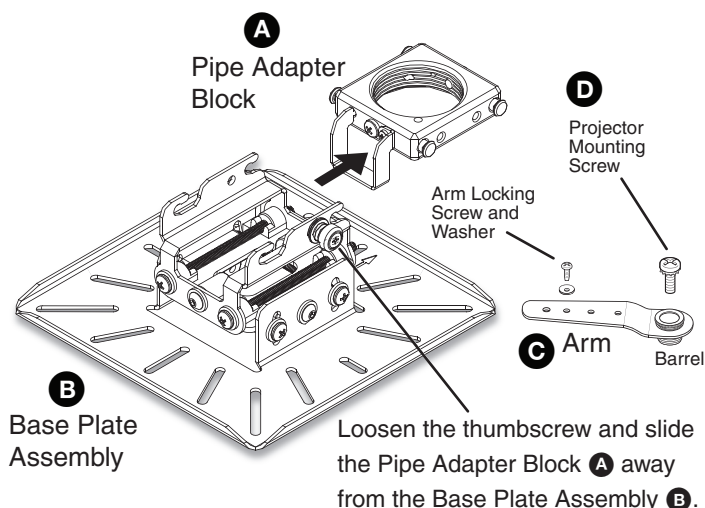

4. Attach the arms to the projector (see the figure at right).

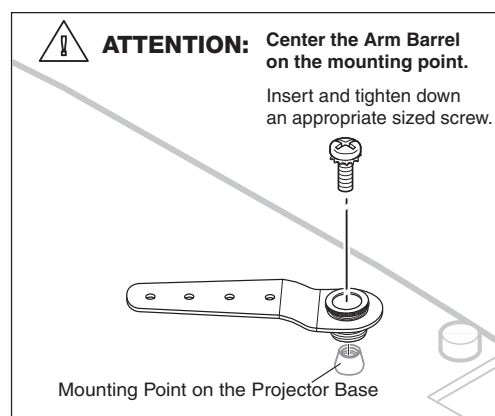

5. Pivot the arms so that they extend towards the center of the projector (see the figure at right).

**It is critical to provide evenly level arms at each mounting point for the Base Plate Assembly to secure to.**

#### ATTENTION:

- Do not overlap the arms.
- Ne pas superposer les pattes de montage.

6. With the arrow on the Base Plate Assembly pointing towards the front of the projector, place the Base Plate Assembly on top of the arms and adjust for slot alignment with the holes in the arms.

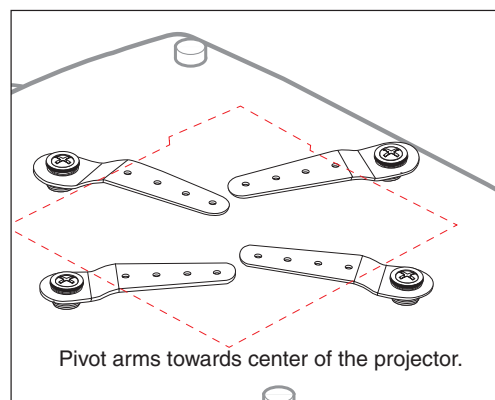

7. Loosely secure each arm to the base plate (see the figure at right).
8. As close as possible, balance the weight of the projector evenly across the Base Plate Assembly. Adjust the Plate on the arms as needed.

#### ATTENTION:

- Distribute the projector weight evenly on the arms.
- Répartissez le poids du projecteur de façon égale sur les pattes.

Lift the assembly at opposite corners to assess if the configuration is approximately balanced.

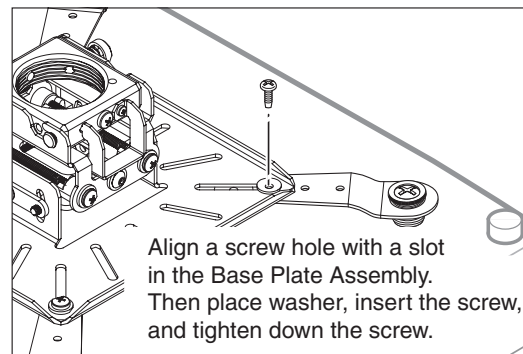

9. **Check for stress on the arms.** To do this, loosen the mounting screws. (do not remove). If the arm or the barrel lifts, this indicates stress on the arm. Adjust the height of the threaded barrels to reduce or eliminate any torque or stress that might be caused by crossed arms or by projector mounting points with differing heights. It is important to keep the arms level and as close (low) to the projector base as possible. Check that the projector weight is still as evenly distributed as possible. Hand tighten all the screws until snug.

**ATTENTION:**

- Do not overtighten the mounting screws as this may damage the projector.
- Ne serrez pas trop les vis de montage au risque d'endommager le projecteur.

**INCORRECT — Arm not level**

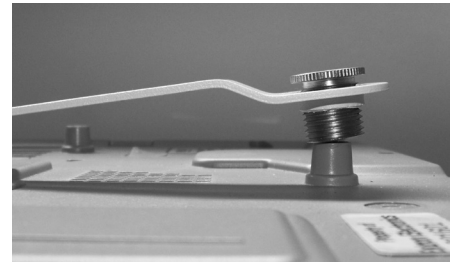

**Causes stress on mounting points**

**CORRECT — Arm level**

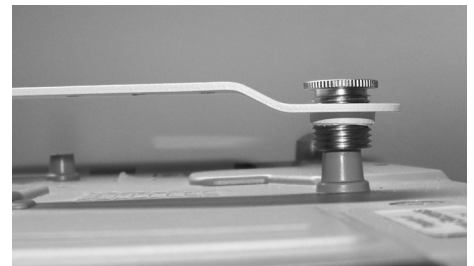

**No stress on mounting points**

**Attaching the Base Plate Assembly to the Pipe Adapter Block**

1. Loosen the two set screws (M5) on the Projector Pipe Block and screw the Block onto the bottom of the pipe (see the figure at right). A minimum of three turns are needed to safely secure the bracket on the pipe.
2. Swing open (down) the cable harness and thread through any cables exiting from the projector pipe (see images at lower right). Close the cable harness. This keeps the cables out of the way when attaching the Base Plate Assembly to the Pipe Adapter Block.
3. Carefully lift the projector up to the Projector Pipe Block and, **with the projector facing forward**, slide the Base Plate Assembly onto the Projector Pipe Block (see the image below). Tighten down the thumbscrew.
4. On the side opposite the thumb screw, insert and tighten down the additional lock screw **E**.

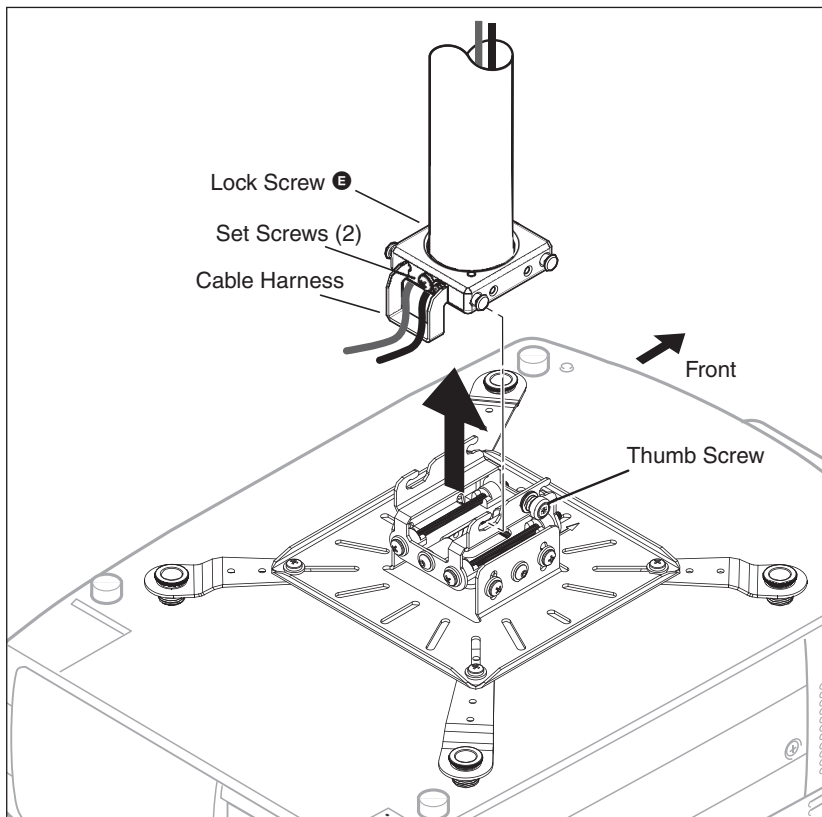

To open cable harness, pull harness out and swing it down.

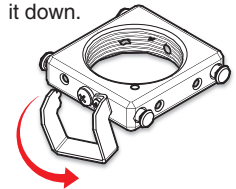

Projector Mounting Pipe

Route cabling.

Close harness.

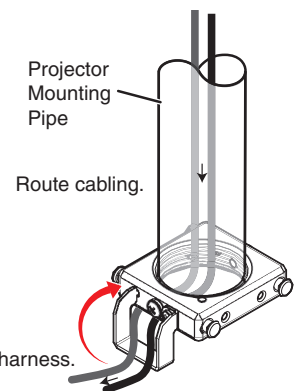

# UPB 125 • Installation Guide (Continued)

## Adjusting the Projector Alignment

### Adjust the rotation (yaw)

Turn the unit on the projector pole to the correct position.  
Secure the position by tightening the two set screws against the pole.

#### ATTENTION:

- Do not turn the unit all the way to the end of the pole or the projector may fall.
- Ne pas tourner l'unité complètement à l'extrémité du pôle au risque de faire tomber le projecteur.

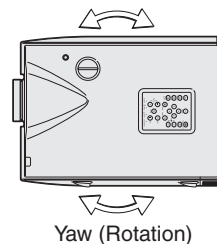

### Adjust the vertical angle (pitch) and horizontal tilt (roll)

1. On the Base Plate Assembly, loosen the vertical angle and horizontal tilt adjustment screws.
2. Adjust the vertical angle (pitch) of the projector to the correct alignment. Tighten down the two vertical angle adjustment screws.
3. Adjust the horizontal tilt (roll) of the projector to the correct alignment. Tighten down the two horizontal tilt adjustment screws.

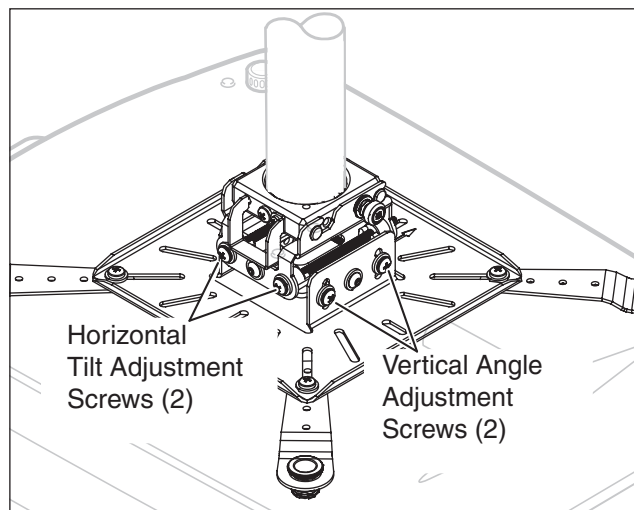
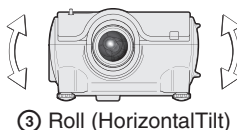
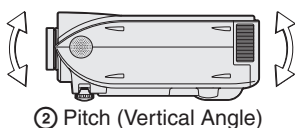

## Installation Checklist

### Planning (page 1)

- ☐ Check the projector:
  - ☐ Weight
  - ☐ Mounting point locations
  - ☐ Minimum and maximum throw distance of the projector
- ☐ Check the mounting location, in particular the structural ceiling loading.
- ☐ Check the local building standards and codes.
- ☐ Check the Americans with Disabilities Act or other accessibility requirements.

### Installation (pages 2 and 3)

- ☐ Separate the Pipe Adapter Block from the Base Plate Assembly.
- ☐ Adjust the barrels on the arms, center on the mounting points, and secure the arms onto the projector.
- ☐ Place the Base Plate Assembly onto the arms, adjust, and secure.
- ☐ Adjust the assembly for weight distribution and torque reduction, and tighten down all the screws.
- ☐ Install and secure the Pipe Adapter Block on the pipe.
- ☐ Attach the Base Plate Assembly with the projector onto the Pipe Adapter Block and secure.

### Finishing the installation (page 4)

- ☐ Adjust the yaw, pitch, and roll.

For information on safety guidelines, regulatory compliances, EMI/EMF compatibility, accessibility, and related topics, see the **Extron Safety and Regulatory Compliance Guide** on the Extron website.