

Retractor for Cable Cubby F55 UT • Installation Guide

IMPORTANT:
Go to www.extron.com for the complete user guide, installation instructions, and specifications.

This guide provides instructions for an experienced technician to install the Extron Retractor for the Cable Cubby® F55 UT Enclosure.

Additional instructions are available in the user guide for the Cable Cubby F55 UT Enclosure at www.extron.com.

NOTE: For information on safety guidelines, regulatory compliances, EMI/EMF compatibility, accessibility, and related topics, see the [Extron Safety and Regulatory Compliance Guide](#) on the Extron website.

Planning

The retractor modules can be mounted inward or outward depending on available under-table clearance and accessibility. Up to two retractor modules can be installed per enclosure.

NOTE: Inward mounting is recommended for installations with limited clearance.

For new installations, to determine the best location for the enclosure, keep in mind the under-table space required for the retractor modules (see [Determining Under-table Clearance](#) for more info).

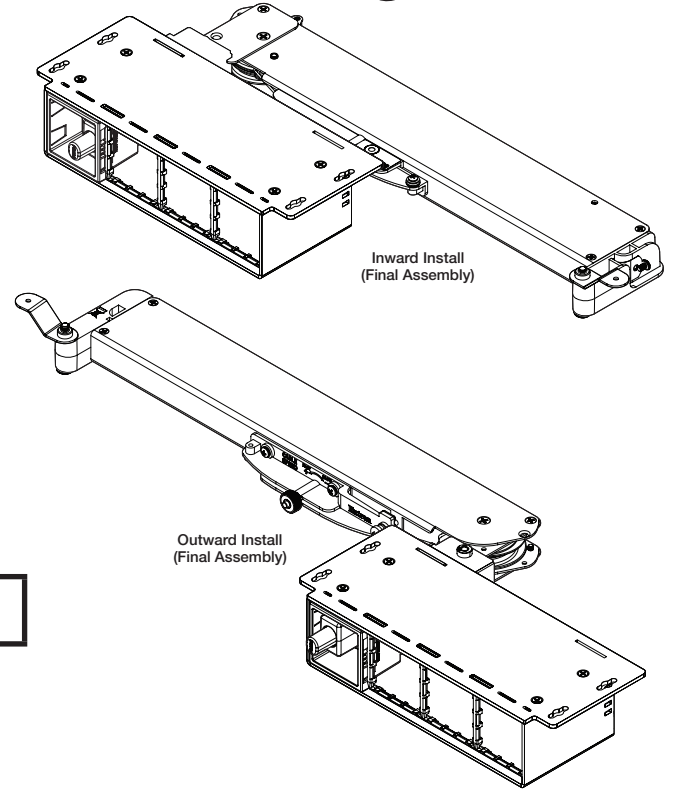

Required Tools and Additional Accessories

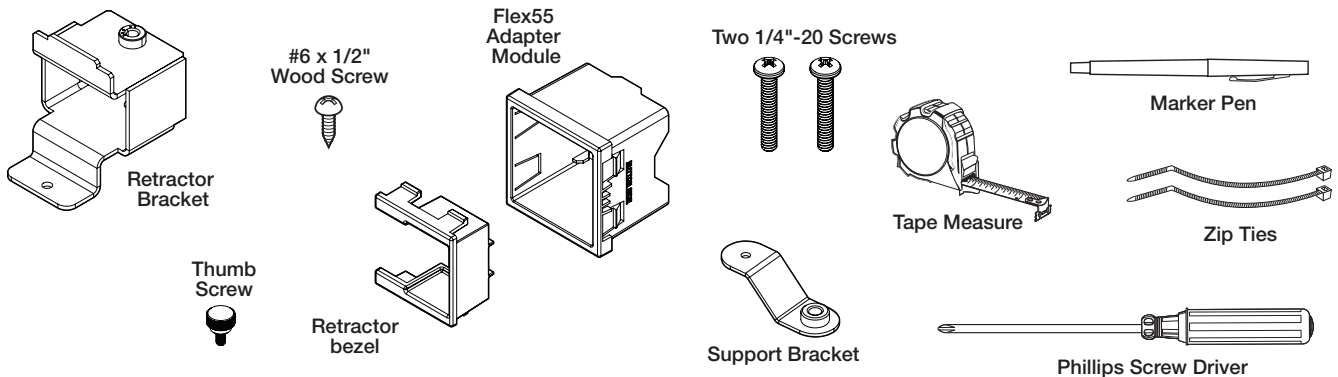

Figure 1. Tools and Accessories

Determining Under-table Clearance

The diagram on the following page shows the space required for a retractor module installation in a Cable Cubby F55 UT enclosure.

NOTES:

- To prevent objects from impeding cable retraction, ensure the exposed cable clears nearby obstructions.
- Excess cabling can cause clearance issues. Use zip ties to secure under-table cabling to prevent accidental contact or entanglement with users.

Retractor for Cable Cubby F55 UT • Installation Guide (Continued)

Mounting Orientations and Dimensions

The following diagrams illustrate the mounting dimensions for outward, double outward, and inward retractor module orientations.

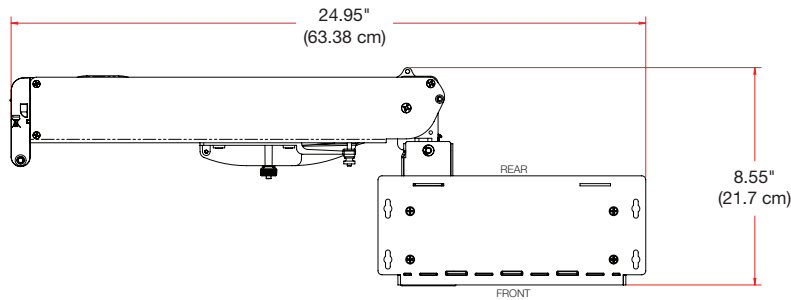

Outward Installation

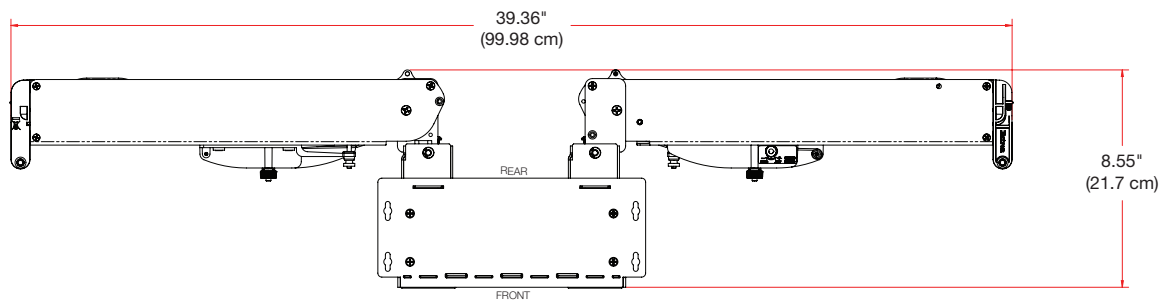

Double Outward Installation

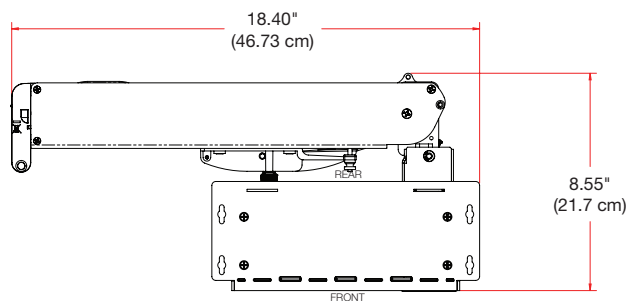

Inward Installation

Figure 2. Cable Cubby F55 UT with Retractor Modules - Mounting Orientations and Dimensions

Preparing the Enclosure

Ensure the retractor has adequate under-table clearance for installation (see previous section). You should have the required accessories for mounting the retractor and to configure the enclosure.

CAUTION: Disconnect the power from the Cable Cubby enclosure before beginning a retractor system installation.

ATTENTION : Débranchez l'alimentation du boîtier Cable Cubby avant de commencer l'installation d'un système de rétracteur.

Preparing the Retractor Modules

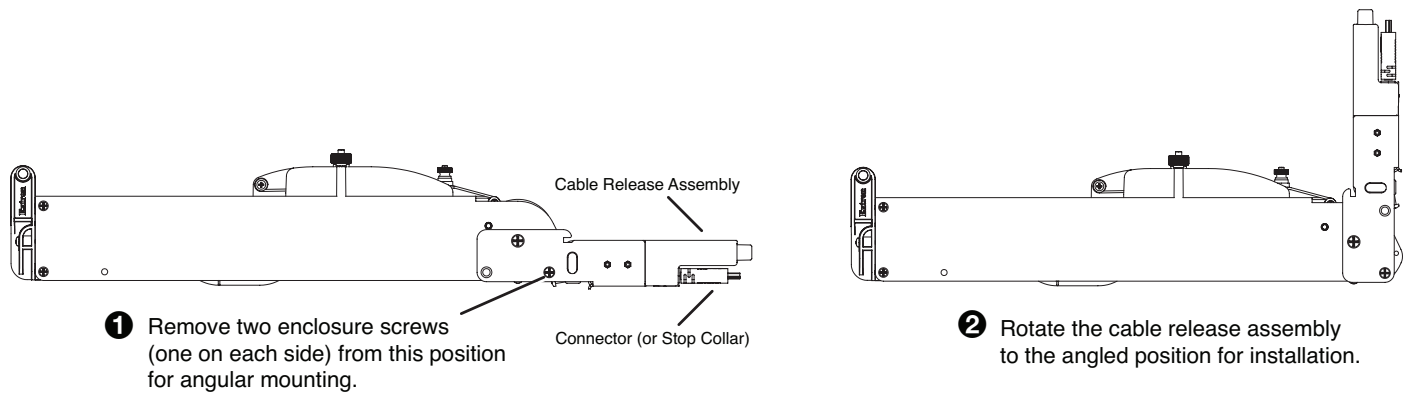

Figure 3. Preparing the Retractor Modules

Installation

Retractor Bracket Installation

Insert the retractor bracket into the desired right or left rear mounting slot (**1**) and secure with the included thumb screw (**2**).

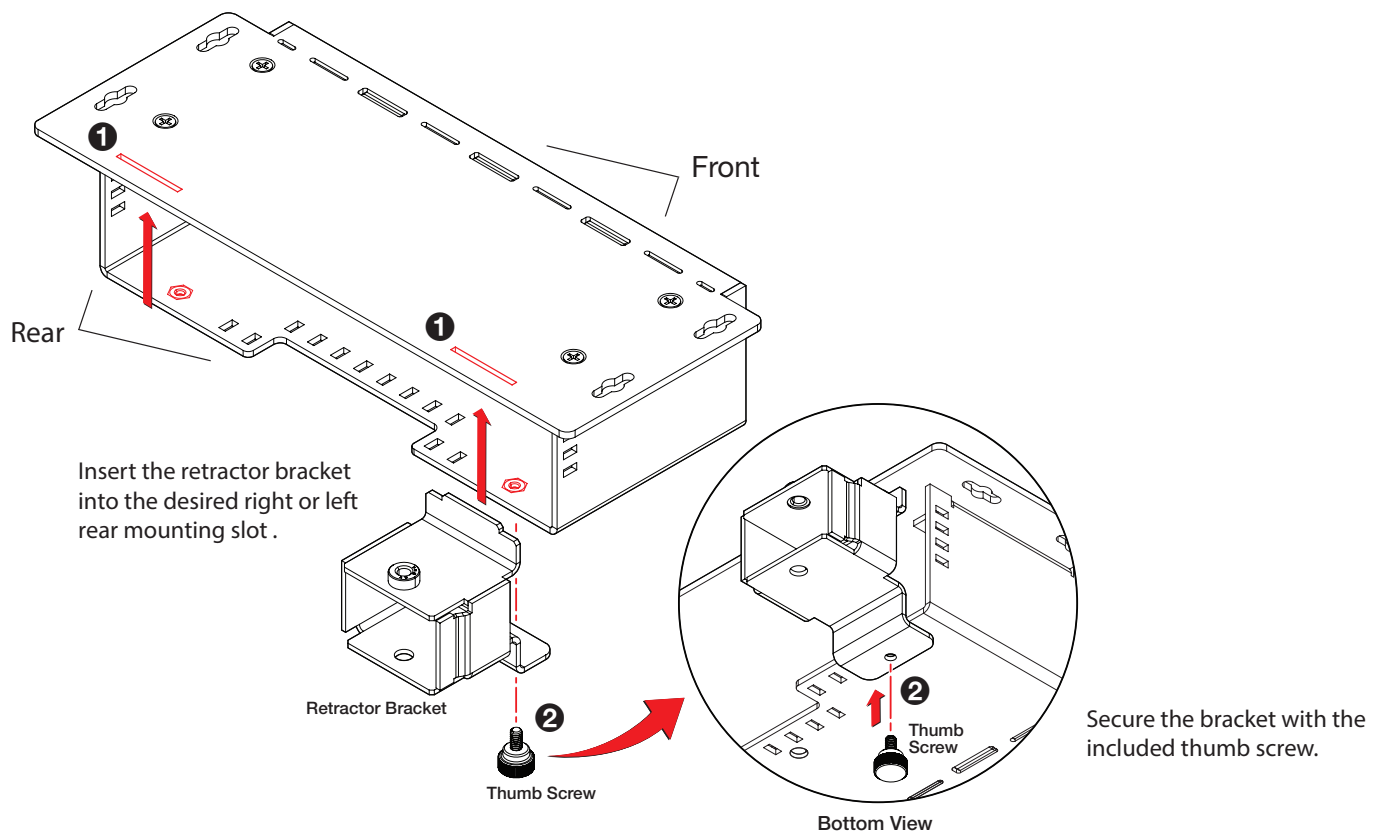

Figure 4. Installing the Retractor Bracket

Plastic Inserts Installation

If installing the Retractor outward, insert the retractor bezel with the opening-side facing outward. If installing inward, install facing inward.

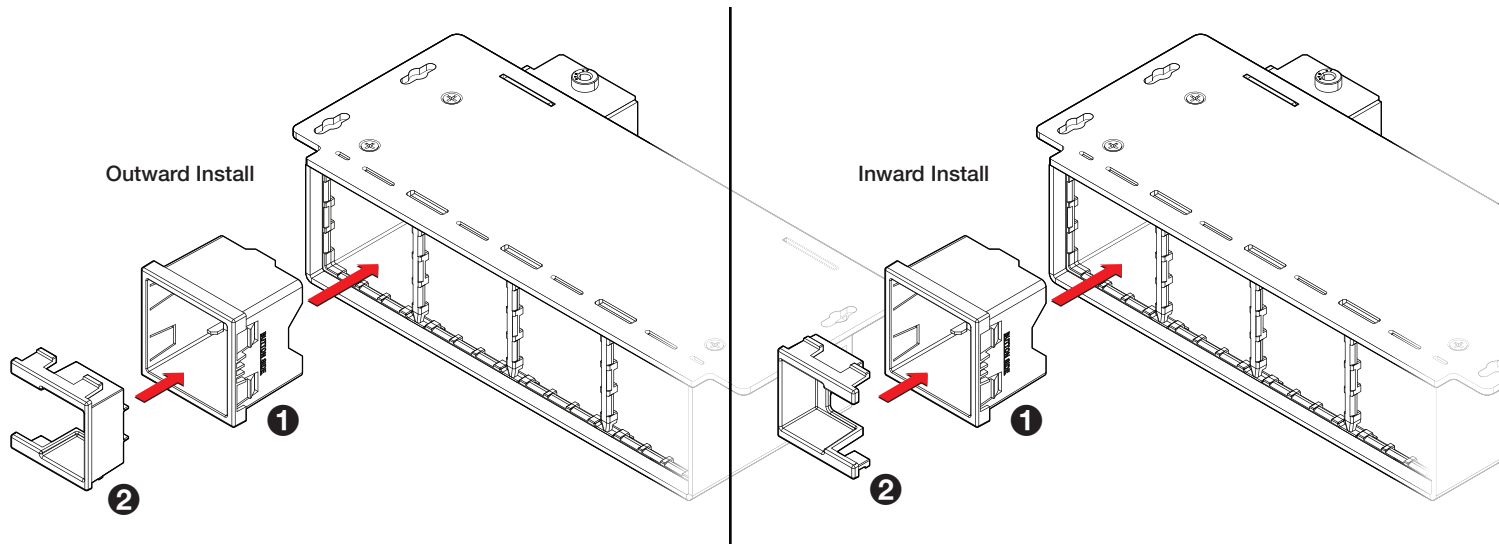

Figure 5. Installing the Flex55 Adapter Module and Retractor Bezel

Support Bracket installation

Attach the support bracket to the retractor end cap, using the provided 1/4"-20 screw.

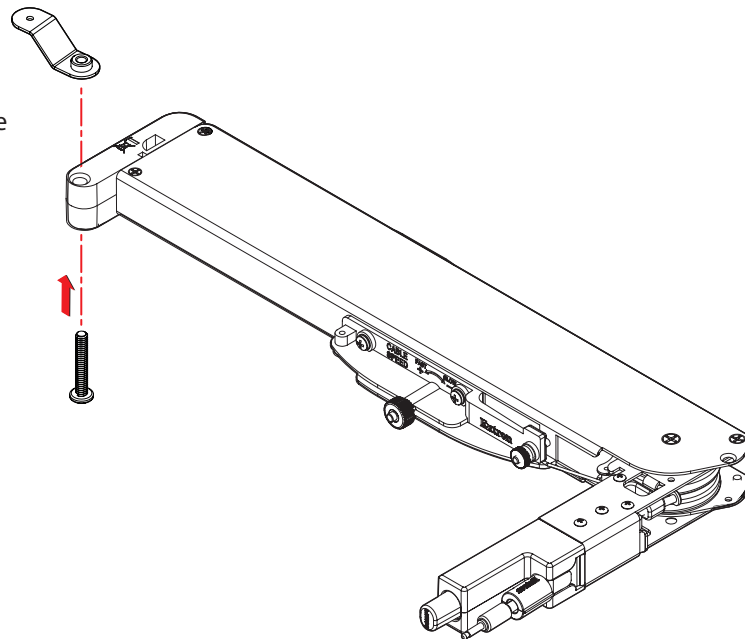

Figure 6. Installing the Support Bracket

NOTE: Do not overtighten. The bracket screw only needs to be snug. Overtightening could deform the end cap and cause misalignment of the retractor, resulting in poor cable extension and retraction.

Retractor for Cable Cubby F55 UT • Installation Guide (Continued)

Retractor Installation

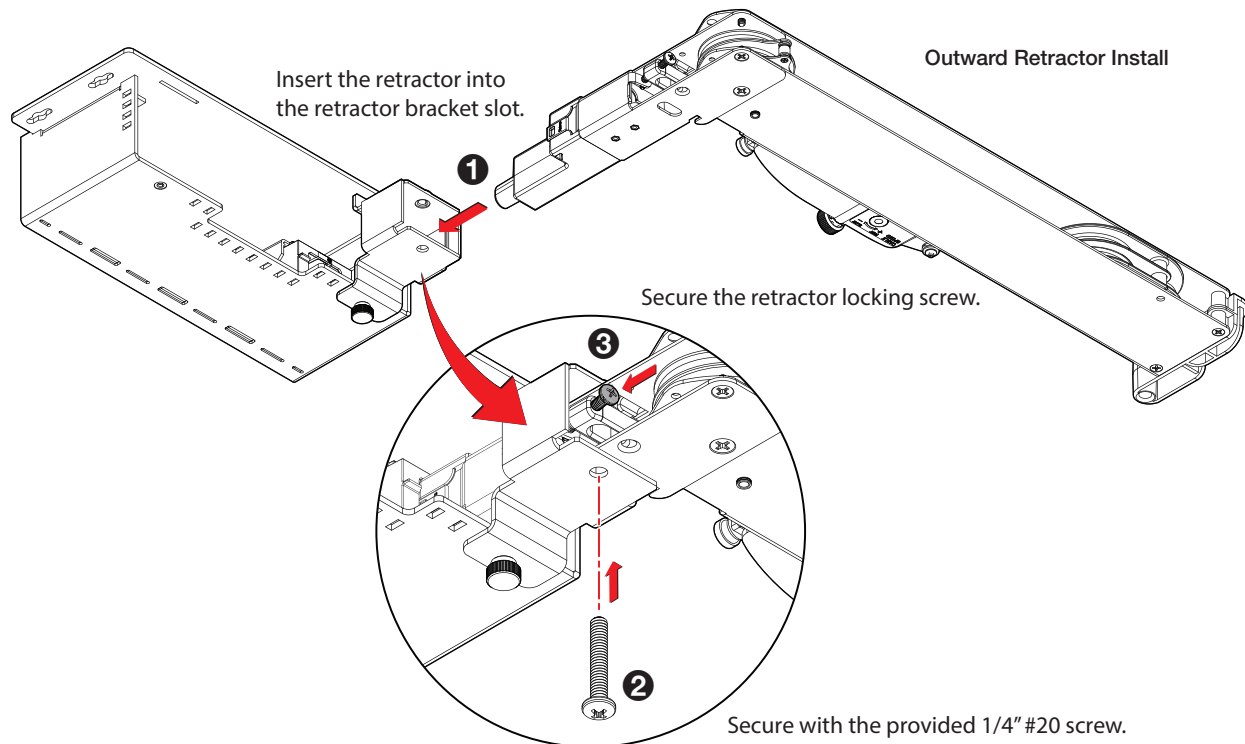

Figure 7. Installing the Retractor into the Cable Cubby F55 UT enclosure

NOTE: Do not overtighten. The locking screw (3) only needs to be snug.

Support Bracket Mounting

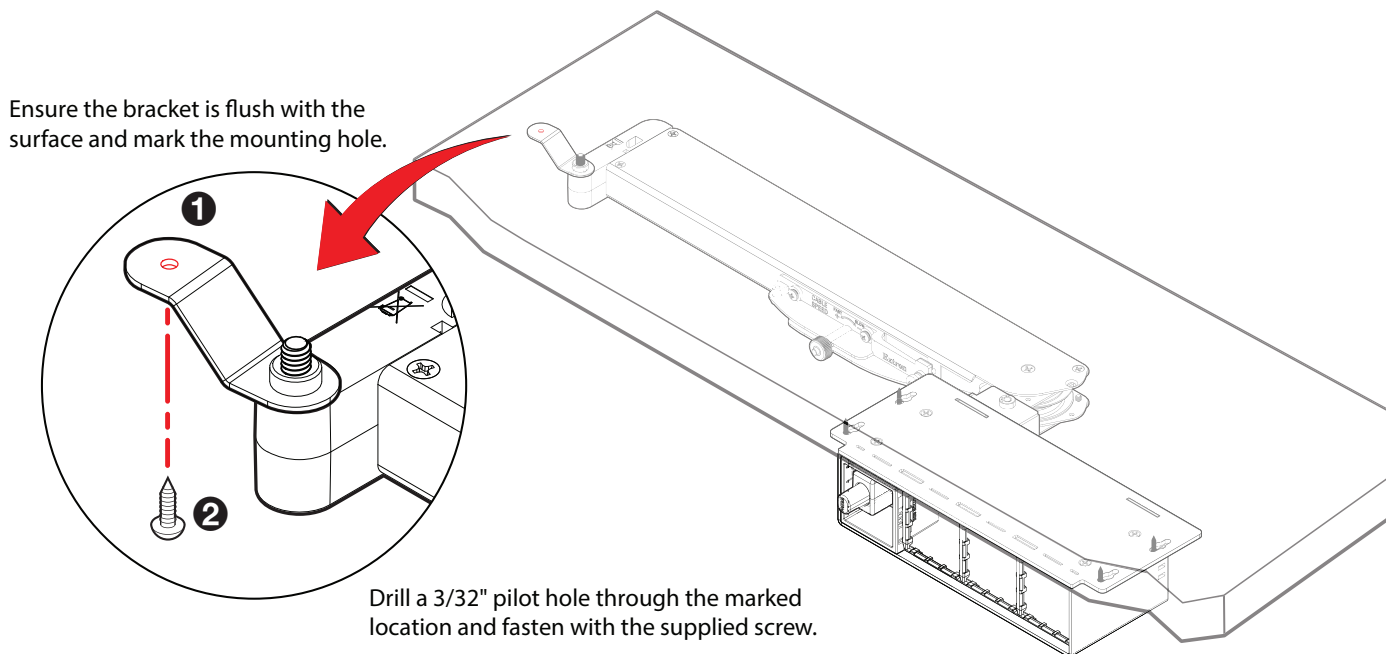

Figure 8. Mounting the Support Bracket

ATTENTION:

- Ensure the supplied #6 - 1/2" L screw does not pierce through the top of the table. Use an appropriate screw based on the table material and thickness.
- Assurez vous que le #6 - 1/2" L vis fournies ne transpercent pas la surface de la table. Utilisez de vis plus appropriées en fonction du matériau de la table et de son épaisseur.

Confirm Proper Cable Extension and Retraction

To extend the cable, hold it by the connector and pull the cable from the retractor module to its full length.

To retract the cable, see the diagram below.

CAUTION: Use one hand to control the cable as it retracts. A cable allowed to retract too quickly and without control can cause possible injury to the user or damage the furniture surface, Cable Cubby, and nearby items.

ATTENTION : Utilisez une main pour contrôler le câble lorsqu'il se rétracte. Un câble qu'on laisse se rétracter trop rapidement et qu'on ne contrôle pas peut provoquer d'éventuelles blessures ou endommager la surface du meuble, du Cable Cubby, ou des objets à proximité.

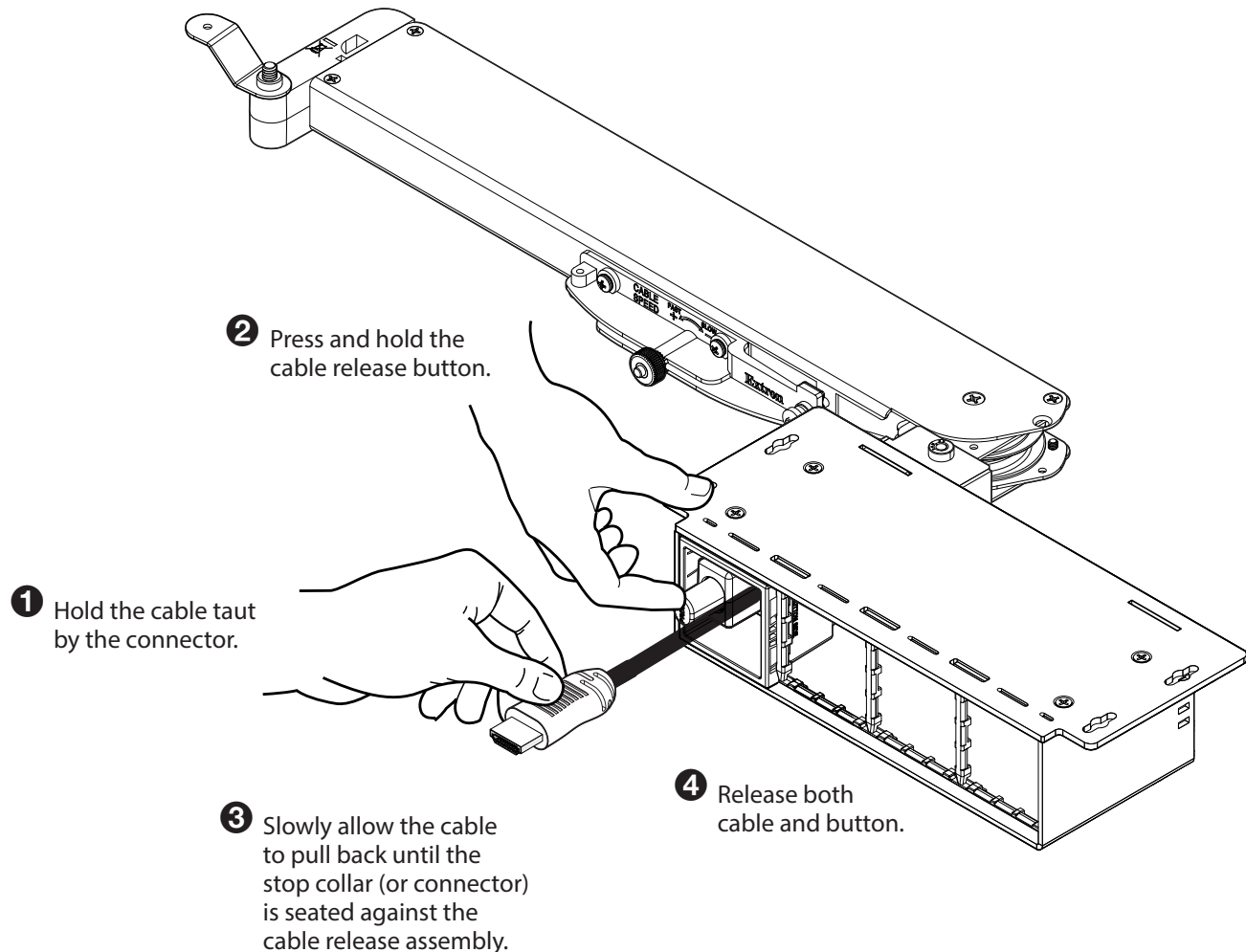

Figure 9. Confirming Proper Cable Retraction

- If the cable does not retract to suit your application, see “Speed Control Adjustment” in the *Retractor Series User Guide* at www.extron.com for more information.
- If the stop collar (or connector) does not seat fully against the cable release assembly, confirm proper tension adjustment using the instructions on the product label.

For information on safety guidelines, regulatory compliances, EMI/EMF compatibility, accessibility, and related topics, see the [Extron Safety and Regulatory Compliance Guide](#) on the Extron website.