

## AC 102 and AC+USB 311 No AC Power Modules for the Cable Cubby Enclosures • Installation Guide

The AC 102 and AC+USB 311 No AC Power Modules provide slots for installing one or two compatible AC outlets (purchased separately) for powering and charging laptops and other portable devices. The No AC Power Modules are compatible with the following outlets:

- **Legrand Israel 572124** — White
- **Legrand India 573471** — White
- **Legrand Israel 572624** — Magnesium
- **Legrand India 573671** — Magnesium

See the CAUTION and ATTENTION notifications before installing the outlets and mounting the power module. Follow the steps below to properly install and secure the module.

### Installing the AC Outlets in the Power Modules

#### CAUTION:

#### ATTENTION :

- All electrical installation should be performed by qualified personnel in accordance with local and national building, fire and safety, and electrical codes.
- Toute installation électrique devrait être effectuée par un personnel qualifié, conformément aux codes du bâtiment, aux codes incendie et sécurité, et aux codes électriques locaux et nationaux.
- To ensure proper electrical grounding, use the provided #6-32 grounding screws and star washers.
- Afin d'assurer une mise à la terre correcte, utilisez les fixations de mise à la terre #6-32 et les rondelles en étoile fournies.

**ATTENTION:** Follow all national and local building and electrical codes that apply to the installation site. Extron is not liable nor responsible for damage or injury as a result of installing this product. It is the responsibility of the qualified installer to ensure applicable safety, compliance, and technical steps have been performed in accordance to regulatory, building and electrical standards.

The AC 102 No AC power module has two slots at the top, through which you can access two sets of cables in order to wire them to the outlets. The AC+USB 311 has one slot and one set of cables for wiring. Each set consists of the following three colored cables:

- **Brown** — Live
- **Blue** — Neutral
- **Green** — Ground

To wire the outlets to the module:

1. Each set of cables (one brown, one blue, and one green) is zip-tied together and placed inside the module (see ① in the illustration at right). Pull one zip-tied set of cables out through each slot, so that the loose ends of the cables are accessible (②).
2. Remove the partially-severed insulation from the ends of the cables to expose the bare wires (③).
3. Place the module on a flat surface with the slots facing up and the word Top (between two arrows pointing up) facing toward you, as shown at right.
4. Attach the wires to each outlet as follows:
  - a. Loosen the three screws on the back of the outlet (see ① in the illustration below, right).
  - b. Insert each wire into the appropriate captive screw connector (use either of the two holes):
    - **Live (brown) cable** — L connector (②)
    - **Ground (green) cable** — Ground connector (③), labeled with  $\perp$ .
    - **Neutral (blue) cable** — N connector (④)
  - c. After inserting each wire, tighten the screw above it to hold it in place (①). Pull gently on each wire to ensure it is securely attached.

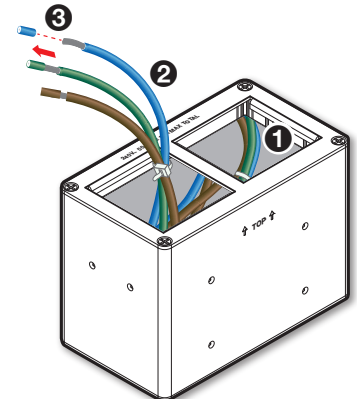

Figure 1. AC 102 Module with Wires

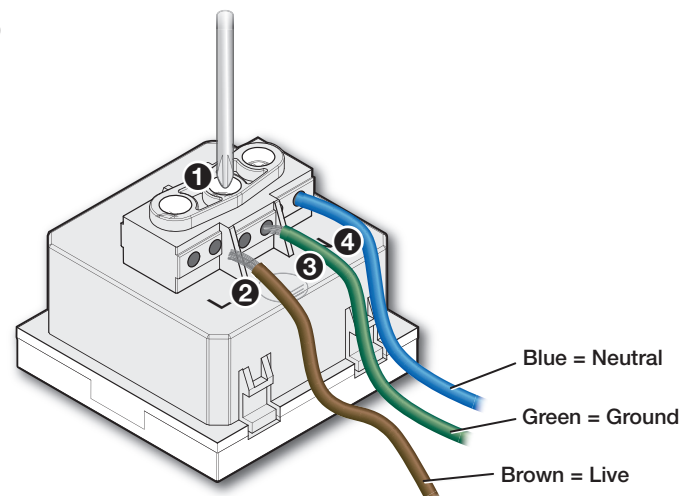
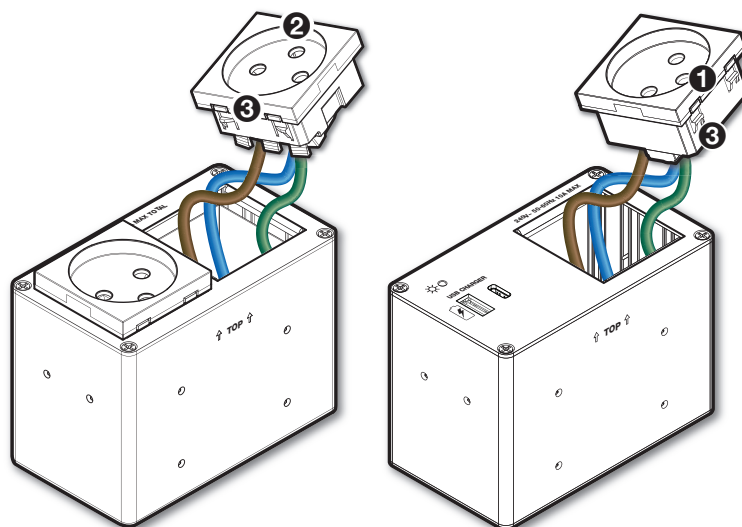

Figure 2. Connecting Wires to AC Outlet

5. Position the outlets to the AC 102 or AC+USB 311 module as shown in figure 3 at right.
  - Place an outlet into the left slot of the AC 102 module or the right slot of the AC+USB 311 module (see figure 3, ①).
  - Place the other outlet of the AC 102 module into the right slot 90 degrees counterclockwise (②).
6. Press each outlet into the slot until the flanges (③) on opposite edges of the outlet snap into place and the outlet is held securely.



**Figure 3.** Position and Snap the AC Outlets into the Power Modules

**Position the AC outlets and install as shown.**

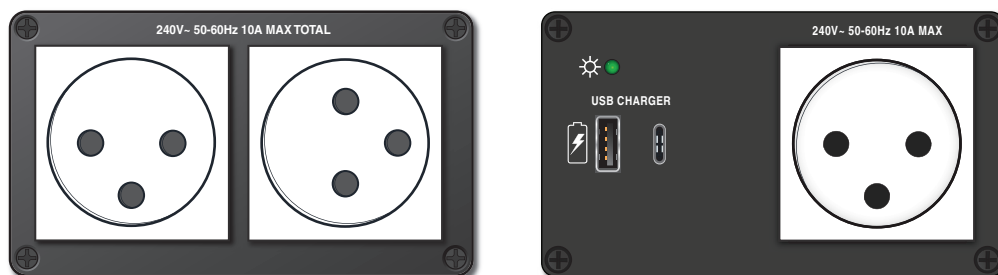

**Figure 4.** Top View of the Power Modules with Israel AC Outlets

## Installing the Assembled Power Module in the Cable Cubby Enclosure

Follow the steps to install and secure the assembled AC power modules for each compatible Cable Cubby enclosure.

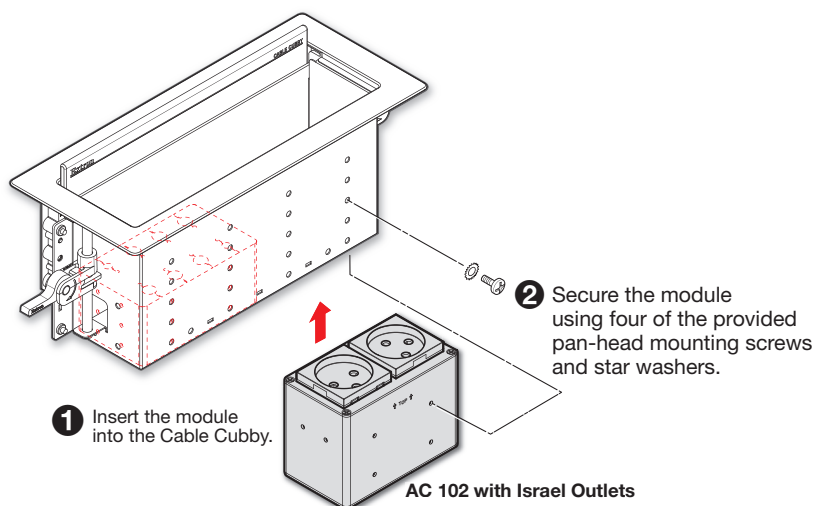

**Figure 5.** Installing the AC 102 Power Module in the Cable Cubby 1202 Enclosure

**NOTE:** To view the power specifications pertaining to this product, see [www.extron.com](http://www.extron.com).

For information on safety guidelines, regulatory compliances, EMI/EMF compatibility, accessibility, and related topics, see the [Extron Safety and Regulatory Compliance Guide](#) on the Extron website.