

TLM 100T • Installation Guide

The TLM 100T is a secure tabletop mounting enclosure for an iPad® in a landscape orientation. The enclosure is compatible with the iPad 2, iPad 3, and iPad 4.

Installing an iPad in a TLM 100T

1. Use the provided Extron removal tool to ease the faceplate away from the back panel. Start by releasing the catches at the bottom and gradually work around the sides until the faceplate lifts off.
2. Remove the metal frame.
3. Remove the base cover, using the Extron removal tool.
4. Run the iPad charging cable through the hole at the bottom of the TLM 100T back panel, then through the cable raceway in the base of the unit, and out the back of the base.

NOTE: Leave about 1½ inches (3.8 cm) of charging cable free to connect to the iPad.

5. Place the iPad in the rear enclosure. The power switch must be in the top left corner.
6. Place the metal frame with the rubber pads in contact with the iPad.
7. Use the provided #6 spanner bit and the eight provided spanner drive screws to secure the metal frame.

ATTENTION: Do not overtighten the screws.

8. Replace the faceplate. Ensure it is in the correct orientation with the Extron name at the bottom.
9. Replace the TLM 100T base cover.

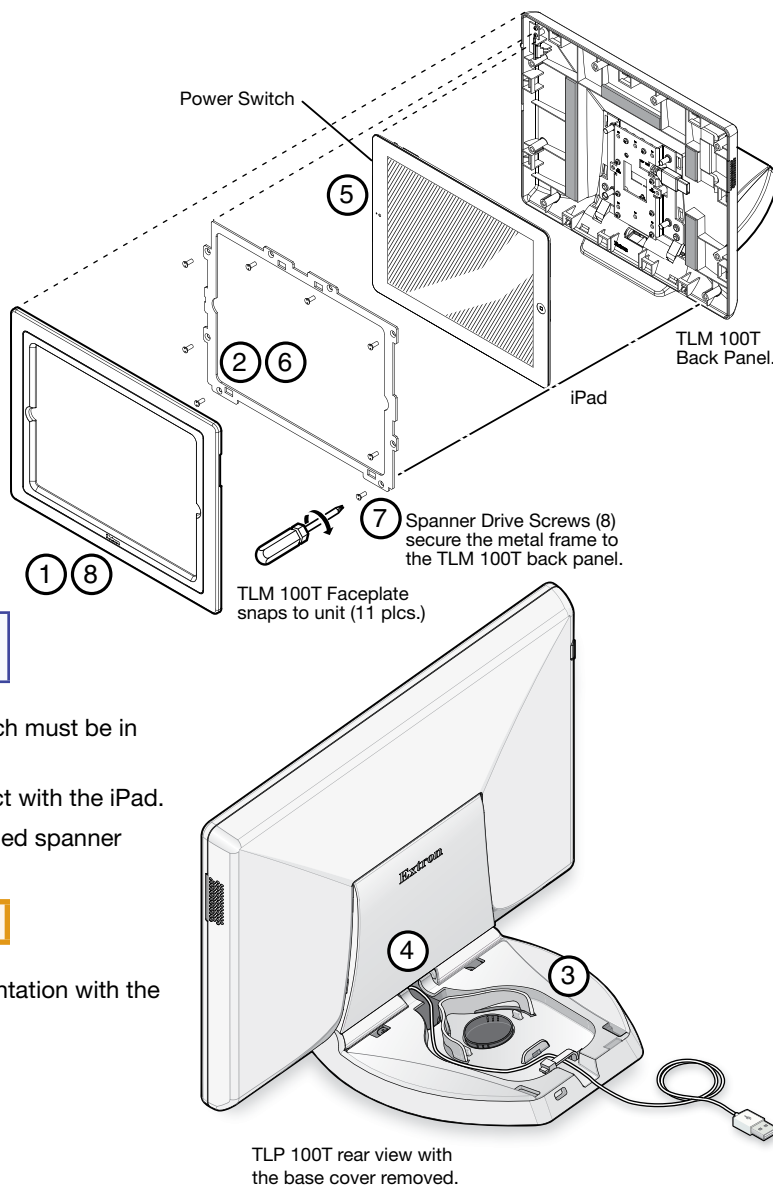

Tabletop Mounting Options

Securing the TLM 100T to a Tabletop

The TLM 100T can stand on any convenient tabletop. If required, use two screws in the two mounting holes in the base to secure the unit to the desktop (see the figure at right).

1. Drill two holes through the desktop. The two holes must be 3.07 inches (78 mm) apart and 3/8 inch (9.5 mm) in diameter.
2. Fasten the base to the desktop with two #8 wood screws (not provided) through the desktop from underneath into the two holes in the base of the TLM 100T.

Installing the TLM 100T on an SMA-1 Swivel Mount

The TLM 100T can be mounted with the Extron SMA-1 swivel mount adapter, allowing it to swivel up to 359° (see the *SMA-1 Swivel Mount Adapter Kit User Guide* at www.extron.com).

1. Determine where the SMA-1 and TLM 100T are to be mounted.
2. Mount the SMA-1 and configure the set screws as described in the *SMA-1 Swivel Mount Adapter Kit User Guide*.
3. Remove the rear and base covers of the TLM 100T, using the Extron removal tool.
4. Remove the hole plug from the base of the TLM 100T to reveal the mounting hole.

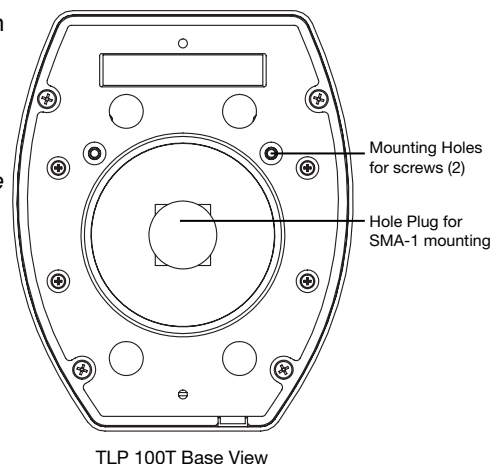

-
- Diagram illustrating the removal of the rear and base covers of the HP Pavilion dv6000 laptop. The diagram shows the laptop with the rear cover and base cover removed, revealing the internal components. The following parts are labeled:
- Power Switch
 - Rear Cover
 - Speaker Cover
 - Notch to Remove Rear Cover
 - Base Cover
 - Notch to Remove Base Cover
 - Slot for Kensington Lock

For additional security, attach a Kensington Security Lock (not provided) to the metal-reinforced slot at the rear edge of the base (see the figure at right), following the instructions provided by the manufacturer.

ATTENTION: Do not install the iPad until after the TLM 100T has been mounted.

1. Remove the base cover.
2. Remove the rear cover.
3. If required, remove the rear enclosure knock-out to route the iPad cable.
4. Remove the four screws holding the hinges to the rear enclosure (see diagram at right).

1. Run the iPad charging cable through the knock-out or the hole at the bottom of the rear enclosure.
2. Locate the four VESA mount holes, marked M4.
3. Follow the instructions of the manufacturer to mount the TLM 100T.
4. Install the iPad as described in “Installing an iPad in a TLM 100T” on the previous page.

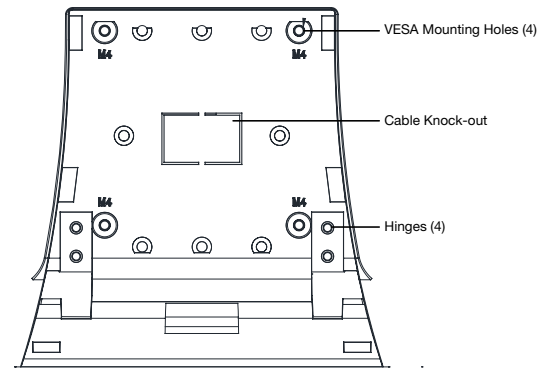

TLM 100T Rear Panel (exterior)

1. Run the iPad charging cable through the knock-out or the hole at the bottom of the rear enclosure.
2. Locate the appropriate holes, using the figure at right.
3. Mount the TLM 100T with the appropriate screws (not provided)
4. Install the iPad as described in “Installing an iPad in a TLM 100T” on the previous page.

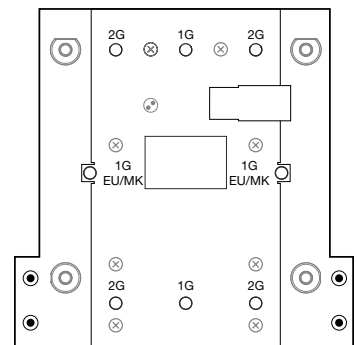

TLM 100T Rear Panel (interior)
 1G = EU or MK Junction Box
 2G = US Junction Box

1. Remove the existing faceplate using the Extron removal tool.
2. Clip the TLM 100A into place.

| | | | | | | | | |
|--|---------------------|--|--------------------------------------|--|-----------------------------------|--|--|-------------------------------------|
| Extron Headquarters | | Extron Europe | Extron Asia | Extron Japan | Extron China | Extron Middle East | Extron Korea | Extron India |
| +1.800.633.9876 (Inside USA/Canada Only) | | +800.3987.6673 (Inside Europe Only) | +800.7339.8766 (Inside Asia Only) | +81.3.3511.7655 +81.3.3511.7655 FAX | +4000.398766 Inside China Only | +971.4.299.1800 +971.4.299.1880 FAX | +82.2.3444.1571 +82.2.3444.1575 FAX | 1800.3070.3777 Inside India Only |
| Extron USA - West | Extron USA - East | | | | | | | |
| +1.714.491.1500 | +1.919.850.1000 | +31.33.453.4040 | +65.6383.4400 | | +86.21.3760.1568 | | | +91.80.3055.3777 |
| +1.714.491.1517 FAX | +1.919.850.1011 FAX | +31.33.453.4050 FAX | +65.6383.4664 FAX | | +86.21.3760.1566 FAX | | | +91.80.3055.3737 FAX |