

## Specifications

### Retractor SM Series

#### Retractor SM Series Show Me Cables

**TRUE 4K**

Max. 4K Capabilities		
Resolution and Refresh Rate	Chroma Sampling	Max. Bit Depth per Color
4096 x 2160 at 30 Hz	4:4:4	8 bit
3840 x 2160 at 30 Hz		
4096 x 2160 at 60 Hz	4:2:0	
3840 x 2160 at 60 Hz		

Frame rate <sup>1</sup> .....	24, 25, 30, 50, or 60 fps
Chroma sampling <sup>1</sup> .....	4:4:4, 4:2:2, or 4:2:0
Color bit depth <sup>1</sup> .....	8 bits per color
Standards <sup>1</sup> .....	HDMI 2.0, DisplayPort 1.2, HDCP 1.4 and 2.3
Maximum video data rate	
HDMI .....	10.2 Gbps (3.4 Gbps per color)
DisplayPort .....	10.8 Gbps (2.7 Gbps per lane)

**NOTE:** <sup>1</sup>Subject to the maximum data rate limit. Use our calculator ([www.extron.com/8KdataRate](http://www.extron.com/8KdataRate)) to determine video parameters supported by this data rate.

#### Retractor SM - Digital

##### HDMI SM Cable

Connector type .....	1 male HDMI type A to 1 male HDMI type A
Voltage .....	30 V
Regulatory compliance .....	UL
Temperature rating .....	80° C

##### DisplayPort SM Cable

Connector type .....	1 male latching DisplayPort to 1 male HDMI type A; active, one-way adapter
Voltage .....	30 V
Regulatory compliance .....	UL
Temperature rating .....	80° C

##### Mini DisplayPort SM Cables

Connector type .....	1 male Mini DisplayPort to 1 male HDMI type A; active, one-way adapter 1 male Mini DisplayPort to 1 male latching DisplayPort
Voltage .....	30 V
Regulatory compliance .....	UL
Temperature rating .....	80 °C

**NOTE:** All SM series cables include a 24 inch (609 mm) control/tally pigtail.

# Specifications • Retractor SM Series (Continued)

## Retractor SM Show Me - Analog

### VGA SMC Cable

Connector type .....	1 male 15-pin HD to 1 male 15-pin HD
Resolution range .....	Up to 1080p
Voltage .....	30 V
Regulatory compliance .....	UL
Temperature rating .....	80 °C

**NOTE:** All SM series cables include a 24 inch (60 cm) control/tally pigtail.

## Retractor SM Network and Audio Cables

### Network cables

Standards.....	Cat 6
Connector type .....	1 male shielded RJ-45 to 1 male shielded RJ-45
Voltage .....	30 V
Regulatory compliance .....	UL
Temperature rating .....	80 °C

### Audio cables

Connector type .....	1 male 3.5 mm stereo audio TRS (tip, ring, sleeve) to 1 male 3.5 mm TRS
Voltage .....	30 V
Regulatory compliance .....	UL
Temperature rating .....	80 °C

## General

Mounting .....	Mountable into Extron TeamWork® Collaboration Systems only (sold separately)
----------------	--

**NOTE:** An optional bracket is required for horizontal mounting.

Enclosure type .....	Metal and plastic
Enclosure dimensions .....	4.3" H x 1.2" W x 26.9" D (10.9 cm H x 3.0 cm W x 68.4 cm D) See the following diagrams for additional dimensions.

# Specifications • Retractor SM Series (Continued)

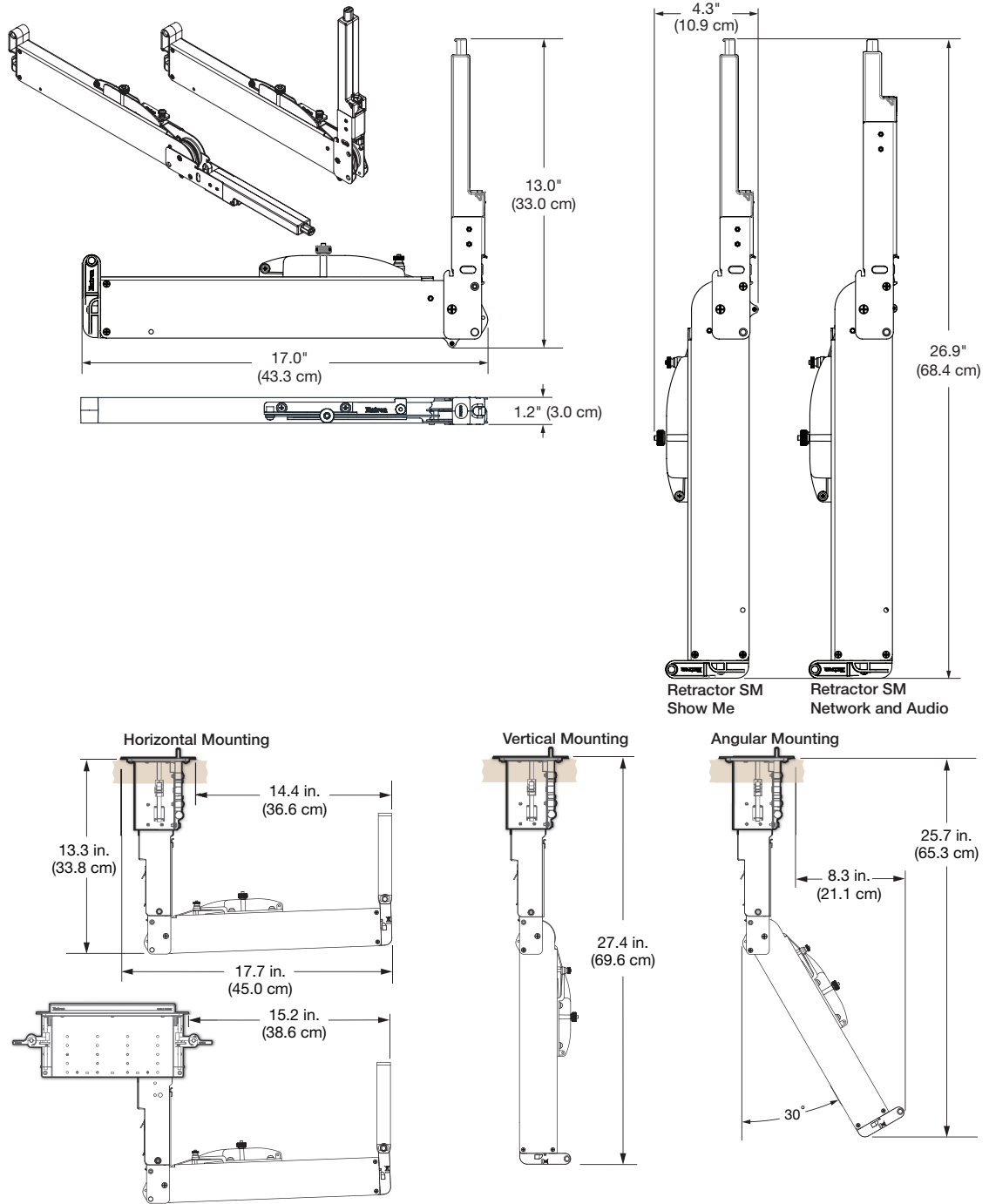

**NOTE:** Shown with optional Cable Cubby 1202 enclosure.

- Product weight ..... 3.5 lbs (1.6 kg)
- Regulatory compliance..... RoHS, WEEE
- Life expectancy..... Tested to exceed 5000 cycles
- Warranty ..... 3 years parts and labor including preinstalled cable assembly

**NOTE:** Specifications are subject to change without notice.

**NOTE:** Shipping weights and dimensions are available at [www.extron.com](http://www.extron.com).