

Custom Engraving Services

Custom Laser Engraving Services for Architectural Connectivity

CUSTOM LASER ENGRAVING SERVICES

Extron is pleased to offer custom laser engraving services for CCR 30, CCB 30, and Cable Cubby 500 CCB Cable Access Enclosure. You can use the custom laser engraving to clearly indicate signal type, input numbers or any labeling required for making signal connections clear and easy.

ENGRAVING SPECIFICATIONS

Standard Letter Size

0.14" (3.5 mm) Tall

Standard Font

Helvetica – engraving is **ALL CAPITAL LETTERS**.

Engraving Process

Letters, numbers, and symbols are laser engraved.

ORDER INFORMATION

To order engraving for any of the products listed above, download the PDF versions of these forms from the Extron Web site at <http://www.extron.com/engraving>. Detailed instructions for completing the form are included in the PDF form.

Submit one Engraving Order Form from each unique plate design. If identical engraving is required on several modules, then submit only one order form for each model number ordered. Be sure to include a purchase order that specifically authorizes purchase of the Extron products as well as the engraving service charges.

FAX SUBMISSION

Fax your completed engraving order form(s) and your purchase order to Extron at: 714.491.1511.

EMAIL SUBMISSION

You can download the PDF version of the order forms from <http://www.extron.com/engraving>. Complete the form(s) electronically and submit them via email to: engraving@extron.com.

For assistance or if you have any questions about our custom engraving services, please contact an Extron Support Representative.

ENGRAVING SAMPLES

Cable Cubby 500 CCB



CCB 30



CCR 30



MODEL	VERSION DESCRIPTION	PART #	MSRP
Set-up Engrave	One-time charge.....	97-001-01	\$50
Engraving	Per unit charge	97-002-01	\$24

Extron

Extron USA - West
Headquarters
+800.633.9876
Inside USA / Canada Only
+1.714.491.1500
+1.714.491.1517 FAX

Extron USA - East
+800.633.9876
Inside USA / Canada Only
+1.919.850.1000
+1.919.850.1001 FAX

Extron Europe
+800.3987.6673
Inside Europe Only
+31.33.453.4040
+31.33.453.4050 FAX

Extron Middle East
+971.4.299.1800
+971.4.299.1880 FAX

Extron Asia
+800.7339.8766
Inside Asia Only
+65.6383.4400
+65.6383.4664 FAX

Extron Japan
+81.3.3511.7655
+81.3.3511.7656 FAX

Extron China
+4000.398766
Inside China Only
+86.21.3760.1568
+86.21.3760.1566 FAX

CABLE CUBBY 500 CCB ENGRAVING ORDER FORM

Please fax or email the completed form with your purchase order.
 Feel free to call us for assistance.

FIELDS BELOW ARE ACTIVE AND CAN BE FILLED ELECTRONICALLY. WHEN COMPLETE, SAVE THE FORM AS A PDF AND EMAIL OR FAX IT WITH YOUR PURCHASE ORDER

Company Name: _____

Contact Name: _____

Phone #: _____

Fax #: _____

Part #: _____

Quantity: _____

Customer PO #: _____

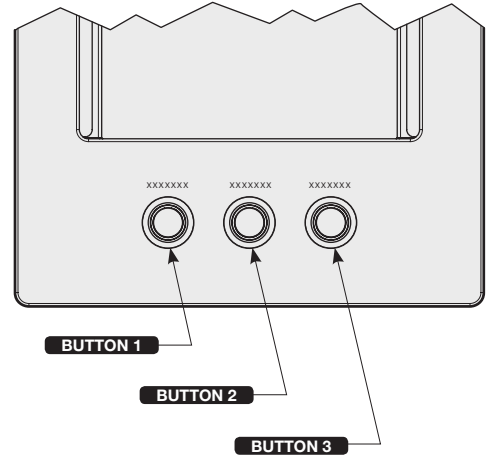

- Important Notice:**
- Purchase Orders for custom labeling cannot be cancelled
 - All sales are final
 - Custom products may not be returned to Extron

I acknowledge and agree to these terms for my custom engraving order
Note: Order will not be processed if acknowledgment box is left un-checked

Note: Helvetica Bold typeface, 0.14" character height, all capital letters. Label is centered over switch.

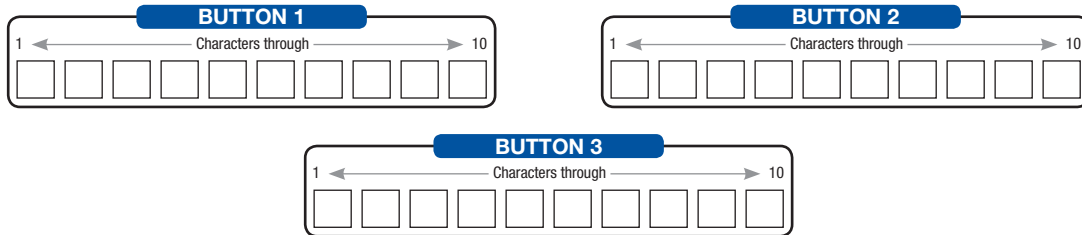

EMAIL OR FAX COMPLETED FORM, ALONG WITH YOUR PURCHASE ORDER, TO YOUR EXTRON CUSTOMER SUPPORT REPRESENTATIVE

FOR EXTRON INTERNAL USE ONLY

EXTRON SO #: _____

Engineering Reference #: _____

Sales Representative: _____



Extron USA - West Headquarters +800.633.9876 <small>Inside USA / Canada Only</small> +1.714.491.1500 +1.714.491.1517 FAX	Extron USA - East +800.633.9876 <small>Inside USA / Canada Only</small> +1.919.850.1000 +1.919.850.1001 FAX	Extron Europe +800.3987.6673 <small>Inside Europe Only</small> +31.33.453.4040 +31.33.453.4050 FAX	Extron Middle East +971.4.299.1800 +971.4.299.1880 FAX	Extron Asia +800.7339.8766 <small>Inside Asia Only</small> +65.6383.4400 +65.6383.4664 FAX	Extron Japan +81.3.3511.7655 +81.3.3511.7656 FAX	Extron China +4000.398766 <small>Inside China Only</small> +86.21.3760.1568 +86.21.3760.1566 FAX
--	--	---	---	---	---	---