

AXI 22 AT D Plus

2 INPUT, 2 OUTPUT DANTE AUDIO INTERFACE
DECORATOR-STYLE WALLPLATE



The Extron **AXI 22 AT D Plus** is a single-gang decorator-style Dante® audio interface for integrating two mic/line sources onto a Dante-enabled audio system. It features two XLR audio inputs and switchable 48 volt phantom power for connecting and powering condenser microphones, and remote control via the network. The AXI 22 AT D Plus also features two analog line outputs for routing any two channels of Dante audio to an analog audio device. The AXI 22 AT D Plus interfaces with any Dante-equipped device over a standard local area network, and can be powered through PoE. This allows a single network cable connection for bidirectional audio, control, and power from a central equipment rack.

- ▶ Two mic/line inputs on XLR connectors insert audio onto a Dante® network
- ▶ Two line outputs on a rear panel captive screw connector extract audio from a Dante network
- ▶ Dante audio networking provides a wide range of expansion capabilities
- ▶ Controlled with DSP Configurator Software or via SIS from a DMP Plus Series processor on the Dante network or a control processor
- ▶ Studio grade 24-bit analog-to-digital and digital-to-analog converters selectable up to 96 kHz
- ▶ Compatible with Extron WPD 100 Series wallplates

DESCRIPTION

The **AXI 22 AT D Plus** accepts two analog mic/line sources, and digitizes them at 24-bit for output via Dante. It is connected into a Dante network over Ethernet using standard IP networking protocols. This avoids the effort and expense of pulling long analog mic/line cables from an audio processor to each wall, floor box, or furniture location. Audio system designers can easily design an audio system with AXI 22 AT D Plus wallplate interfaces throughout a large facility, each connecting back into a central equipment location over a standard network infrastructure.

For additional integration convenience, AXI 22 AT D Plus wallplate interfaces can be remotely powered through Power over Ethernet - PoE, using Extron XTP PI 100 and XTP PI 400 power injectors, network switches equipped with PoE, or midspan PoE injectors. Input gain, output attenuation, and phantom power settings are controlled via SIS from a DMP Plus Series processor on the Dante network or IPCP Pro xi Series control processor.

The AXI 22 AT D Plus can accept any two digital audio channels from the Dante network and provide them as line level analog audio signals. These outputs can be connected into an amplifier, or an optional, single-gang Extron decorator-style wallplate with two XLR audio outputs. The XLR outputs are ideal for recording, or an ALS - assistive listening system.

PANEL DRAWINGS

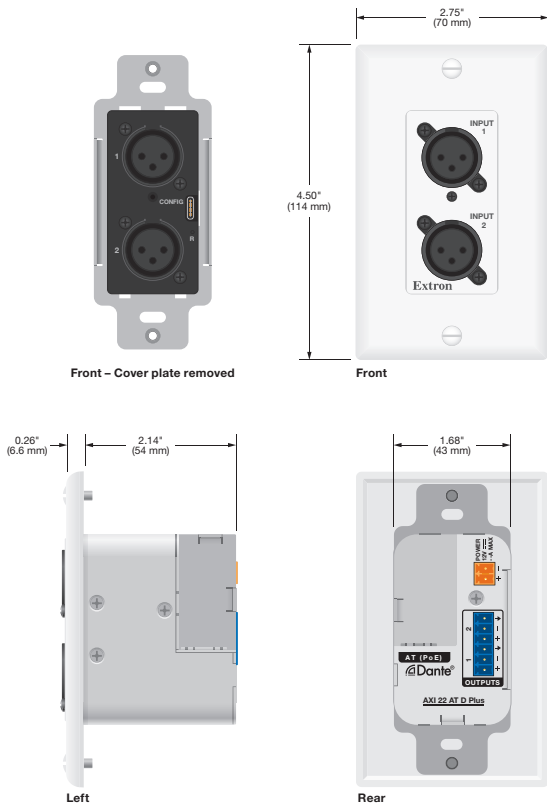

SPECIFICATIONS

AUDIO		
Gain	Unbalanced output: -6 dB, balanced output: 0 dB	
Frequency response	20 Hz to 20 kHz, ± 0.2 dB	
THD + Noise	<0.01% @ 1 kHz at maximum level	
S/N	Analog In to Digital Out: 105 dB, 20 Hz to 20 kHz, at maximum input (unweighted) Digital In to Analog Out: 105 dB, 20 Hz to 20 kHz, at maximum output (unweighted)	
Crosstalk	<-90 dB @ 1 kHz, fully loaded	
Output attenuation	-100 dB to 0 dB (in 1 dB steps)	
AUDIO INPUT		
Number/signal type	(2) mono mic/line, balanced/unbalanced	
Impedance	>10k ohms, balanced/unbalanced	
Nominal level	+4 dBu when level is set to 0 dB gain, adjustable from -60 dBu to +4 dBu	
Maximum level	>+21 dBu (at rated THD + N) when input gain is set to 0 dB	
Equivalent input noise	<-120 dBV (1 μ Vrms) at 40 dB gain	
Input gain adjustment	-18 dB to +60 dB, 1 dB steps, adjustable per input	
Mic phantom power	+48 VDC $\pm 10\%$, can be switched on or off	
AUDIO OUTPUT		
Number/signal type	2 mono (or 1 stereo), balanced/unbalanced	
Nominal level	-10 dBV (316 mV) or +4 dBu (1.23 V)	
Maximum level (Hi-Z)	>+21 dBu balanced or >+15 dBu unbalanced	
AT PORTS — AUDIO TRANSPORT		
Transmission	Dante/AES-67, software selectable	
Audio format	Uncompressed, 24-bit, selectable at 44.1, 48, 88.2, or 96 kHz	
Latency	Deterministic, based on user selection: 1.0 ms (default), 2.0 ms, 5.0 ms	
GENERAL		
Power input requirements	12 VDC or Power over Ethernet (PoE 802.3af)	
Power supply (optional)	External	
Input	100-240 VAC, 50-60 Hz	
Output	12 VDC, 0.5 A, 6 Watts	
Power consumption	Device: 3.59 watts Device and power supply: 4.30 watts	
Product warranty	3 years parts and labor	
NOTE: All nominal levels are at $\pm 10\%$.		
Model	Version Description	Part number
AXI 22 AT D Plus	2x2 Dante Audio Interface, Decorator Style	60-1947-01
AXI 22 AT D PLUS & WPD 102 XLRM	AXI 22 AT D Plus & WPD 102 XLRM Kit - Black	60-1942-22
AXI 22 AT D PLUS & WPD 102 XLRM	AXI 22 AT D Plus & WPD 102 XLRM Kit - White	60-1942-23

For complete specifications, please go to www.extron.com
Specifications are subject to change without notice.

WORLDWIDE SALES OFFICES

Anaheim • Raleigh • Silicon Valley • Dallas • New York • Washington, DC • Toronto • Mexico City
Paris • London • Frankfurt • Stockholm • Amersfoort • Moscow • Dubai • Tel Aviv • Sydney • Melbourne
Bangalore • Mumbai • New Delhi • Singapore • Seoul • Shanghai • Beijing • Hong Kong • Tokyo

www.extron.com