

Setup Guide — RGB 560 AKM

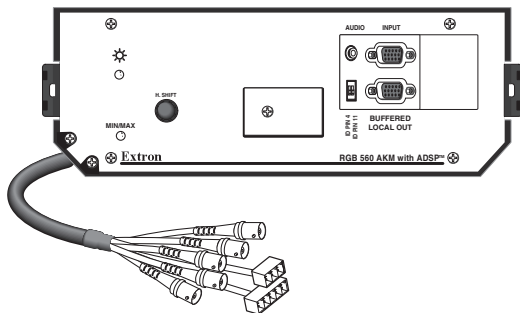

IMPORTANT:
Refer to www.extron.com for the complete user manual and installation instructions before connecting the product to the power source.

The Extron RGB 560 AKM Architectural Interface is an analog, computer video and audio interface with 300 MHz video bandwidth. It installs in an Ackermann floorbox. This guide provides basic instructions for setting up the RGB 560 AKM.

Step 1 — Set the DIP switches behind the access cover

- a. Using a small Philips screwdriver, remove one screw to take off the access cover.

- b. Set DIP switches 1 through 8 to On (up) or Off (down) as desired.

1 — Sync on green

2 — DDSF (up) or ADSP (down [default])

3 — Serration pulse

4 — Composite sync output

5 — Force negative horizontal and vertical sync polarity

6 — Vertical sync pulse width

7 and 8 — Composite sync routing for Macintosh monitors:

- For Macintosh 13": Set 7 to Off (down) and 8 to On (up).

- For all other Macintosh: Set 7 to On (up) and 8 to Off (down).

No other combinations are valid.

- c. Replace the access cover.

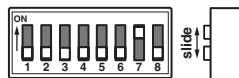

Step 2 — Set the gaining and peaking adjustment jumpers

If using cable runs over 125 feet (38 m) you may need to adjust the gain and peaking jumpers (located inside the unit) to compensate for signal loss, as follows:

- a. Disconnect power from the RGB 560.

- b. Remove six front panel screws and take off the faceplate. Do not pull the output cables out of the enclosure.

- c. Use needlenose pliers to move gain/peaking jumpers J16 (blue), J17 (red), and J18 (green). Place the jumpers on the pins that yield the best image display:

- Pins 3 and 4: Increase the output signal and add 50% of the maximum peaking.

- Pins 2 and 3: Provide unity output (0.7 volts with no peaking [default]).

- Pins 1 and 2: Increase the output signal and add 100% of the maximum peaking (for very long cable runs).

- d. Reattach the faceplate and replace the screws removed in step 2b.

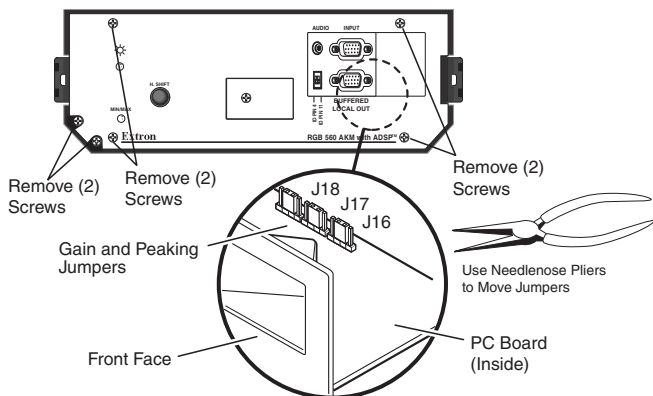

(Continued on reverse side)

Setup Guide — RGB 560 AKM, cont'd

Step 3 — Set the ID bit DIP switches

Set the Pin 4 and the Pin 11 ID bit DIP switches on the front panel to On (up) if **no** local monitor is connected to the Buffered Local Out connector, or to Off (down) if a local monitor is attached.

Step 4 — Connect the video and audio output cables

- Connect the output device to the BNC connectors on the RGB 560's 6 inch output cable.
- Wire the ground, left channel, and right channel wires to the provided 5-pin captive screw connector as shown below. Connect the audio output cable to the 5-pin captive connector on the 6 inch output cable.

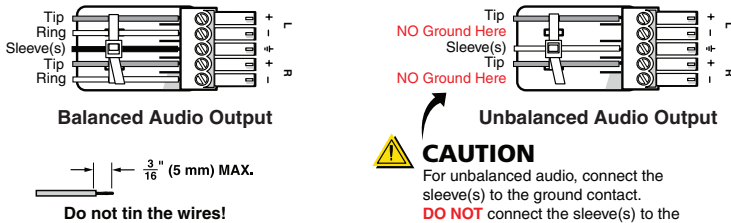

Step 4 — Connect power

- Wire the provided 3-pin captive screw connector to a 12 to 24 VDC or 12 to 24 VAC, minimum 0.5 A external power supply. Plug the power supply cable into the 3-pin captive screw connector on the RGB 560 6 inch output cable.
- Connect power to the input and output devices and turn them on.

Step 5 — Temporarily connect input and local monitor output cables

To test the system, connect the audio input, computer video input, and local monitor output cables to the front panel Audio jack and to the 15-pin HD Input and Buffered Local Out connectors.

Step 7 — Check and adjust the image

Check the image on the screen. If necessary, make adjustments to cables, DIP switches, and jumpers. Adjust the horizontal shift (H. Shift knob) as needed.

Step 8 — Disconnect the input and local monitor output cables

Temporarily disconnect the audio and video input cables and the local monitor output cable.

Step 9 — Install the interface in the Ackermann floorbox

You can install up to three interfaces in the Ackermann floorbox. Refer to the instructions provided with the floorbox for the procedure.

Step 10 — Reconnect the input and local monitor cables

Reconnect the input device audio and video cables and the local monitor's output cable to the front panel. Use the front panel H. Shift knob to readjust the horizontal centering as needed.

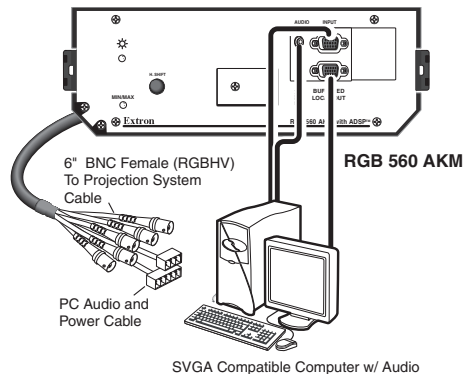

Application diagram

Extron USA - West Headquarters +800.633.9876 Inside USA / Canada Only +1.714.491.1500 +1.714.491.1517 FAX	Extron USA - East +800.633.9876 Inside USA / Canada Only +1.919.863.1794 +1.919.863.1797 FAX	Extron Europe +800.3987.6673 Inside Europe Only +31.33.453.4040 +31.33.453.4050 FAX	Extron Asia +800.7339.8766 Inside Asia Only +65.6383.4400 +65.6383.4664 FAX	Extron Japan +81.3.3511.7655 +81.3.3511.7656 FAX	Extron China +400.883.1568 Inside China Only +86.21.3760.1568 +86.21.3760.1566 FAX	Extron Middle East +971.4.2991800 +971.4.2991880 FAX
--	--	---	---	--	--	--

© 2009 Extron Electronics. All rights reserved.

68-468-50
Rev. A
12 09